

PSU Fall Career Fair

Employer Information

Thank you for registering to attend Fall Career Fair at Pittsburg State University. Please find below helpful information you may need to prepare for this event.

Date & Time

Thursday, October 12, 2023, 10:00am – 2:00pm

- Check-in will begin at 8:30 for those wishing to set up early
- **Please enter the east door of the Overman Student Center** – employers will check-in downstairs, and then proceed to the second floor to your booth (see maps)
- Please try to arrive by 9:30 and ready for students at 10:00 am

Location

- Overman Student Center ([View PSU Campus Map](#))
 - Second Level (See *attached building map*)
- **GPS Address: 302 East Cleveland, Pittsburg, KS**

Parking

- There is a large parking lot located north of the Newman Center and Grubbs Hall, along East Williams Ave (*see attached map*). Please note there are several one-way streets around campus. Williams is a one-way street going west, so plan to enter from Joplin Street.
- Look for a sign that says "*Employer Drop Off*" You may unload your materials/displays, etc. at this location. Students will be available to assist you.
- Parking tickets should not be issued this day. However, if you should receive a ticket please return it to a member of the Career Development staff.

Lunch

- Lunch will be served in the Heritage Room of the Overman Student Center from 11:30 am – 1:00 pm.
- Your check-in packet will contain different colored lunch tickets which indicate your assigned lunch session.
- Please attend your assigned session only. Seating will be in the Governors room in the Overman Student Center and is limited.

Booth and Table Displays

If you are **shipping display boxes** and carts, please address displays to: Career Development, c/o “Your Company”, 1701 South Broadway, Pittsburg, KS 66762. (We recommend getting a tracking number!)

- Booth Space is limited. Your space will be approximately 8’ wide by 6’ deep.
- You will need to include a return shipping label if you would like us to ship it back after the event.
- If you requested access to electricity, we will do our best to accommodate this request, but have a backup plan just in case.

Lodging in Pittsburg

Hampton Inn and Suites

1285 U.S. 69 Hwy
620-231-3100

Lamplighter Inn & Suites

4020 Parkview Drive
620-231-8700
1-866-478-4660

Comfort Inn & Suites

4009 North Parkview Drive
620-231-8800

Regency Inn and Suites

4023 Parkview Drive
620-232-2800

Holiday Inn Express

4011 North Parkview Drive
620-231-1177

La Quinta Inn and Suites

2410 S Broadway
620-670-5614



Parking Here

**Additional
Parking Here**

Drop Off

Enter Here



Jack H. Overman
Student Center

S Elm St

E Williams St

E Williams St

E Williams St

S Joplin St

E McPherson Dr

E McPherson Dr

E McPherson Dr

Clay St

Campus Visits Parking,
Blue Parking Lot

Hughes Hall

Horace Mann - Student
Welcoming Center

St. Pius X Catholic

Grubbs Hall

Leonard H. Axe Library

Porter Hall

Yates Hall & Planetarium

Heckert - Wells Hall

PITT STATE

Carnie Smith Stadium

Google

The Oval

The oval

ss Hall

Overman Student Center

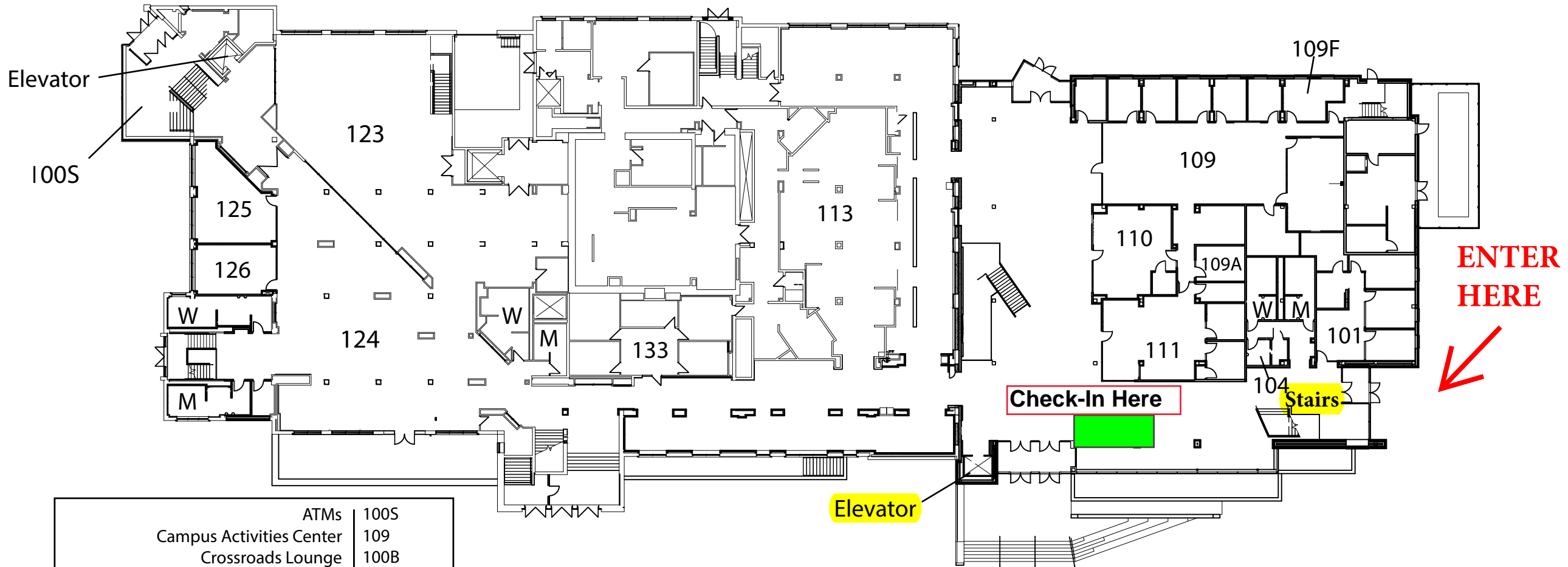

| | |
|--------------------------------------|------|
| ATMs | 100S |
| Campus Activities Center | 109 |
| Crossroads Lounge | 100B |
| Gorilla Activities Board | 110 |
| Gorilla Book Store by Barnes & Noble | 123 |
| Gorilla Crossing Food Court | 113 |
| Gorillas In Your Midst | 109F |
| Gorilla Lounge | 124 |
| Greek Life Office | 109A |
| Heartland Meeting Room | 126 |
| Personal Health Room | 104 |
| Quiet Lounge | 125 |
| Student Center Administration | 101 |
| Sodexo Food Service | 133 |
| Student Government Association | 111 |

First Level

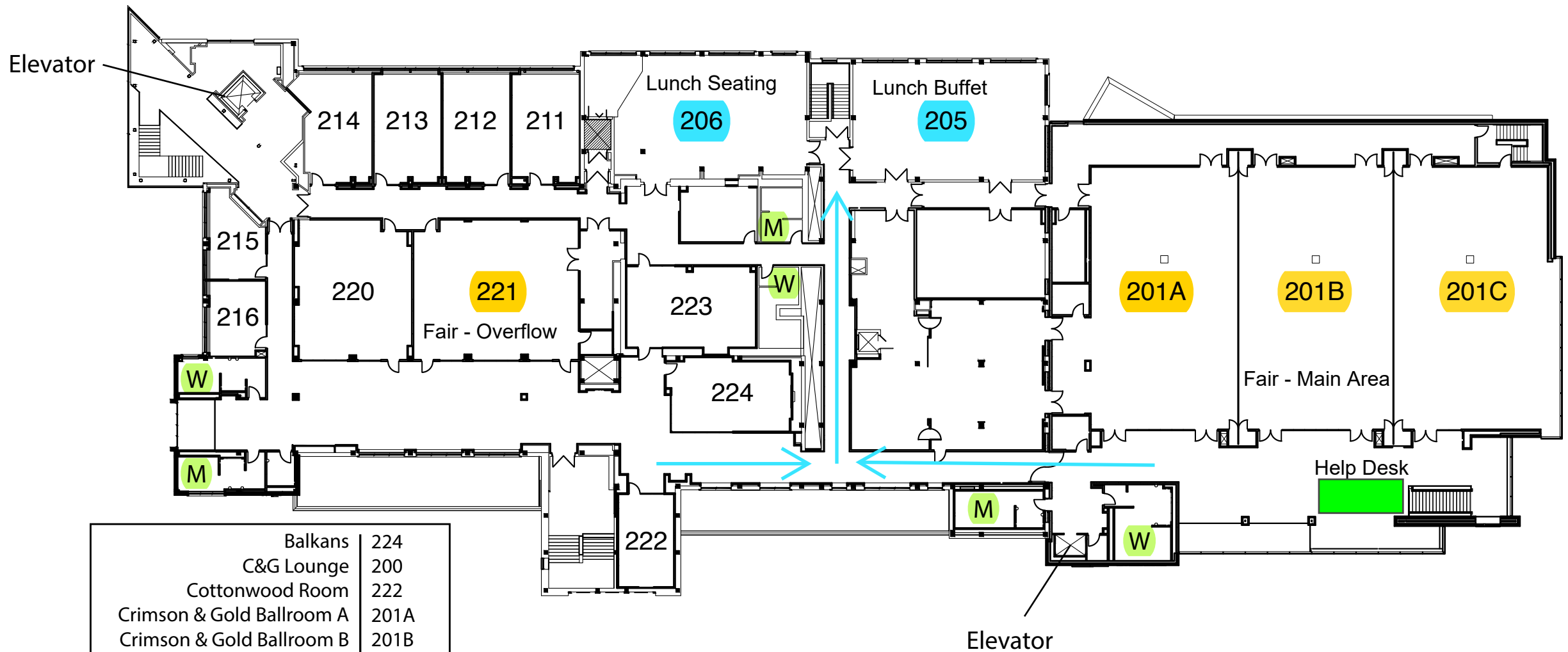

Second Level